



PVVM1707

Preview

VRV

R-410A

50 Hz

Ceiling Mounted Cassette (Single Flow) Type

New

FXEQ20AV36 / FXEQ25AV36

FXEQ32AV36 / FXEQ40AV36

FXEQ50AV36 / FXEQ63AV36

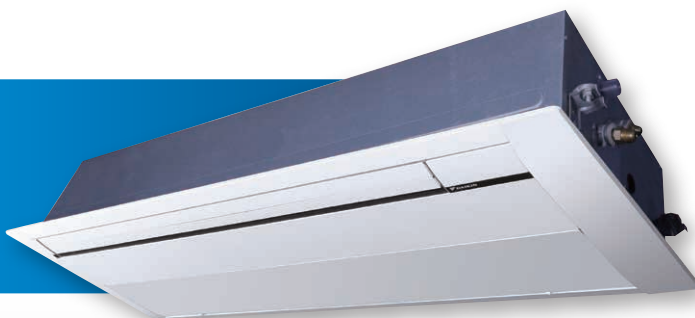

Slim design  
for flexible installation





# Slim design for flexible installation



\* Install the AR application, AReader.  
Refer to the back cover page for details.



- The body features a compact design with a height of just 200 mm and depth 470 mm, making the installation possible in tight ceiling spaces.

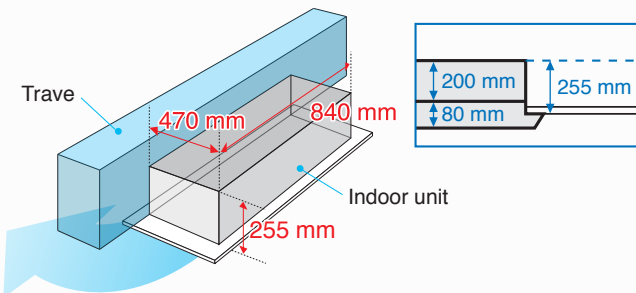

- The unique air discharge mode brings airflow all the way to the floor during heating operation, thus making the better heating effect.

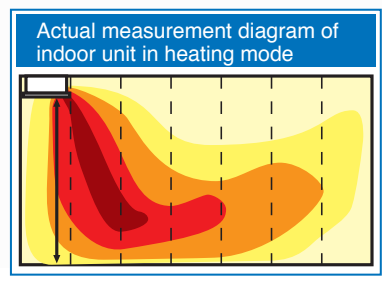

Note: The actual values measured by our company.



- The swinging of horizontal and vertical swing flaps can be adjusted freely with the remote controller, providing 3D airflow to every corner of the room.

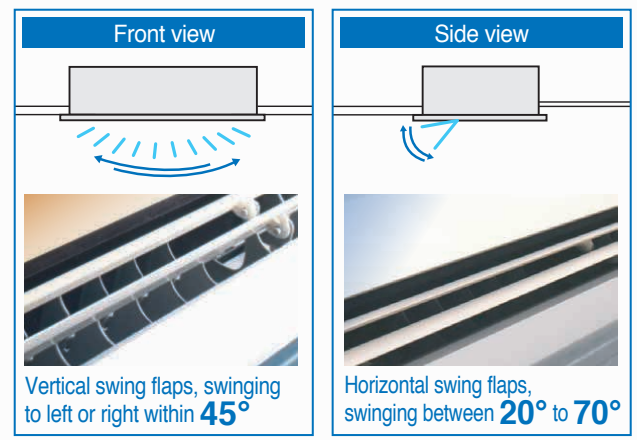

- Control of airflow rate can be selected from 5-step control and quiet operation mode, which provides comfortable airflow.
- DC motor is adopted both in the fan and drain pump of the indoor unit, not only enhancing the energy saving performance, but also reducing the operating sound and the vibration incurred to the unit.

- While creating a cozy indoor environment, the unit can prevent the suspended ceiling from being soiled by adjusting its louvre angle.



- The novel smooth panel design makes dust difficult to accumulate, thus causing the cleaning more conveniently.

- Drain pump is equipped as standard accessory with 850 mm lift.

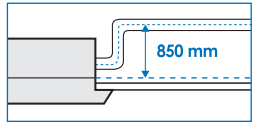

- Servicing of common parts such as the control box etc. can be performed easily only with the suction panel removed.

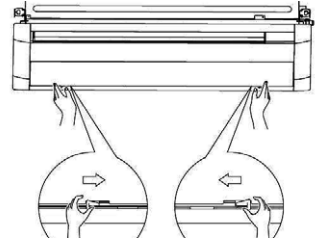

## New Remote Controller\* (Option)



BRC4M61 (Heat Pump)  
BRC4M63 (Cooling Only)

### Wireless Remote Controller

- Stylish new design giving more satisfaction of ownership
- Comes in white colour
- User-friendly buttons with new functions such as 2 flaps control, 5-step airflow control, automatic airflow
- Back light function helps operating in dark rooms

### LCD Backlight



The LCD panel lights up during use, making the remote controller easy to handle even in dark.

\*The new wireless and wired remote controllers are available for Single Flow Cassette FXEQ series only.

### Navigation Remote Controller (Wired Remote Controller)

New functions such as 2 flaps control, 5-step airflow control, automatic airflow can be also adjusted with the new wired remote controller.



BRC1F61

## Specifications

| MODEL                         |                   |        | FXEQ20AV36                                | FXEQ25AV36          | FXEQ32AV36          | FXEQ40AV36           | FXEQ50AV36              | FXEQ63AV36               |
|-------------------------------|-------------------|--------|---|---------------------|---------------------|----------------------|-------------------------|--------------------------|
| Power supply                  |                   |        | 1-phase, 220-240 V, 50 Hz                 |                     |                     |                      |                         |                          |
| Cooling capacity              |                   | kcal/h | 1,900                                     | 2,400               | 3,100               | 3,900                | 4,800                   | 6,100                    |
|                               |                   | Btu/h  | 7,500                                     | 9,600               | 12,300              | 15,400               | 19,100                  | 24,200                   |
|                               |                   | kW     | 2.2                                       | 2.8                 | 3.6                 | 4.5                  | 5.6                     | 7.1                      |
| Heating capacity              |                   | kcal/h | 2,200                                     | 2,800               | 3,400               | 4,300                | 5,400                   | 6,900                    |
|                               |                   | Btu/h  | 8,500                                     | 10,900              | 13,600              | 17,100               | 21,500                  | 27,300                   |
|                               |                   | kW     | 2.5                                       | 3.2                 | 4.0                 | 5.0                  | 6.3                     | 8.0                      |
| Capacity index                |                   |        | 20  | 25                  | 32                  | 40                   | 50                      | 63                       |
| Power consumption             | Cooling           | kW     | 0.026                                     | 0.027               | 0.034               | 0.046                | 0.048                   | 0.067                    |
|                               | Heating           |        | 0.022                                     | 0.023               | 0.030               | 0.042                | 0.044                   | 0.063                    |
| Casing                        |                   |        | Galvanised steel plate                    |                     |                     |                      |                         |                          |
| Airflow rate<br>(H/HM/M/ML/L) | Cooling           | m³/min | 6.0/5.4/4.9/4.4/4.0                       | 6.9/6.4/5.8/5.3/4.8 | 8.0/7.5/7.0/6.3/5.5 | 9.8/8.8/7.8/7.0/6.2  | 12.5/11.4/10.4/9.5/8.7  | 15.0/13.6/12.2/11.0/9.8  |
|                               |                   | cfm    | 212/191/173/155/141                       | 244/226/205/187/169 | 282/265/247/222/194 | 346/311/275/247/219  | 441/402/367/335/307     | 530/480/431/388/346      |
|                               | Heating           | m³/min | 6.0/5.6/5.1/4.7/4.2                       | 7.2/6.7/6.1/5.6/5.0 | 8.6/8.0/7.4/6.7/6.0 | 10.2/9.3/8.4/7.6/6.8 | 14.0/12.8/11.6/10.7/9.8 | 16.9/15.3/13.6/12.3/11.0 |
|                               |                   | cfm    | 212/198/180/166/148                       | 254/237/215/198/177 | 304/282/261/237/212 | 360/328/297/268/240  | 494/452/409/378/346     | 597/540/480/434/388      |
| Sound level<br>(H/HM/M/ML/L)  | Cooling           | dB(A)  | 30/29/28/27/26                            | 32/31/30/29/28      | 35/34/33/32/30      | 38/37/35/33/31       | 38/37/35/33/31          | 43/41/39/37/35           |
|                               | Heating           |        | 33/31/29/28/26                            | 35/33/31/30/28      | 38/36/34/33/31      | 41/39/37/35/33       | 41/39/37/36/34          | 46/44/42/40/38           |
| Dimensions (HxWxD)            |                   | mm     | 200x840x470                               |                     |                     |                      | 200x1,240x470           |                          |
| Machine weight                |                   | kg     | 17  |                     |                     | 18                   | 23                      |                          |
| Piping connections            | Liquid (Flare)    | mm     | ϕ 6.4                                     |                     |                     |                      |                         | ϕ 9.5                    |
|                               | Gas (Flare)       |        | ϕ 12.7                                    |                     |                     |                      |                         | ϕ 15.9                   |
|                               | Drain             |        | PVC26 (External Dia, 26/Internal Dia, 20) |                     |                     |                      |                         |                          |
| Panel<br>(Option)             | Model             |        | BYEP40AW1                                 |                     |                     |                      | BYEP63AW1               |                          |
|                               | Colour            |        | Fresh white                               |                     |                     |                      |                         |                          |
|                               | Dimensions(HxWxD) | mm     | 80x950x550                                |                     |                     |                      | 80x1,350x550            |                          |
|                               | Weight            | kg     | 8.0                                       |                     |                     |                      | 10.0                    |                          |

Note: Specifications are based on the following conditions:  
• Cooling: Indoor temp.: 27°CDB, 19°CWB, Outdoor temp.: 35°CDB, Equivalent piping length: 7.5 m, Level difference: 0 m.  
• Heating: Indoor temp.: 20°CDB, Outdoor temp.: 7°CDB, 6°CWB, Equivalent piping length: 7.5 m, Level difference: 0 m.  
• Capacity of indoor unit is only for reference. Actual capacity of indoor unit is based on the total capacity index. (See Engineering Data Book for details.)  
• Sound level: Anechoic chamber conversion value, measured at a point 1 m in front of the unit and 1 m downward.



## Option List

| Item   |               |              | Type    | FXEQ20AV36 | FXEQ25AV36 | FXEQ32AV36 | FXEQ40AV36 | FXEQ50AV36 | FXEQ63AV36 |
|--|---------------|--------------|---------|------------|------------|------------|------------|------------|------------|
| Decoration panel                                       |               |              |         | BYEP40AW1  |            |            |            | BYEP63AW1  |            |
| Remote controller                                      | Wireless type | Heat pump    | BRC4M61 |            |            |            |            |            |            |
|  |               | Cooling only | BRC4M63 |            |            |            |            |            |            |
| Navigation remote controller (Wired remote controller) |               |              |         | BRC1F61    |            |            |            |            |            |
| Remote sensor  |               |              |         | KRCS01-4B  |            |            |            |            |            |

## How to use AReader

### 1 Install the AR application, AReader.

This application is available for smartphones. Download the AReader application from Google Play or the App Store for free. Data communication may be charged. Recommended to use under Wi-Fi condition.

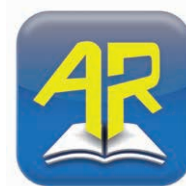

### 2 Start the AReader application.

Place your smartphone over the marker\* and the contents will be displayed.

\*Refer to the cover page and page 1 for the AR markers.